



NEW! HIGH FLOW 2-WAY 10 MM MINIATURE VALVES

Specifications

Medium: Air, Gas or other Compatible Fluids

Working Pressure: 0 to 30 psig/2.0 bar

Max. Flow Rate: 28 lpm (1.0 scfm)

Orifice: 0.055" (1.4 mm)

Response Time: 8 ms when energized; 10 ms when de-energized

Electrical: 12 VDC or 24 VDC

Power Consumption: 3.5 watts in rush phase; 15 ms/0.35 watts in maintenance phase

Voltage Tolerance: -5% to 10%

Material: Stainless steel core and springs, nylon body, FKM dynamic seals, and Buna-N gasket and static seals. FKM gasket and static seals available, consult factory.

Temperature Range: 23 to 122°F (-5 to 50°C). When below 32°F (0°C), must use clean, dry air

90° Connector with LED

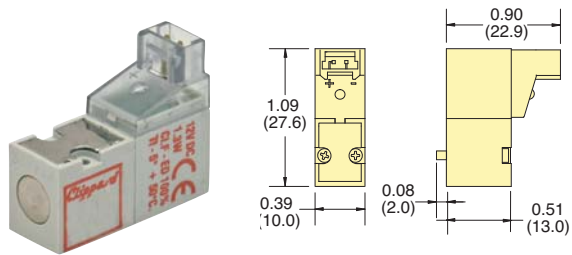

In-Line Connector with LED

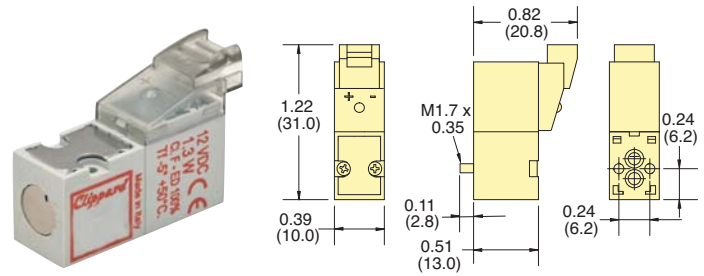

Part No.	Connector	Voltage
E210H-3L012	90° Connector	12 VDC
E210H-3L024	90° Connector with LED	24 VDC
E210H-3C012	In-Line Connector	12 VDC
E210H-3C024	In-Line Connector with LED	24 VDC

Typical Air Flow

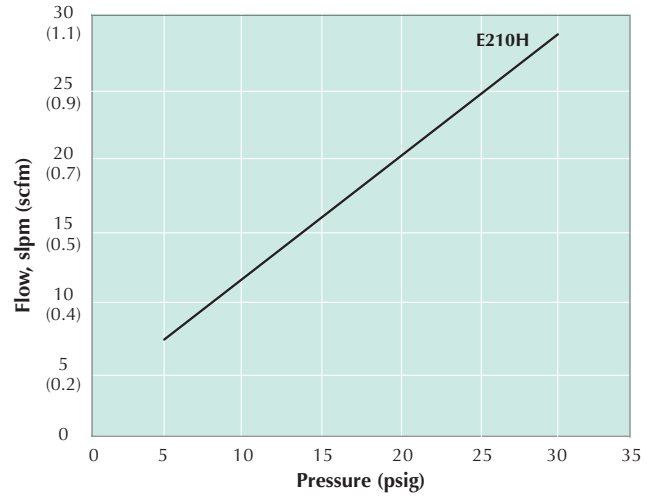

Mounting Interface

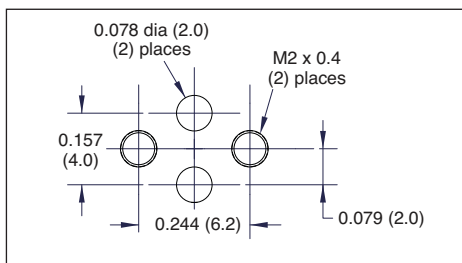

10 mm High Flow Single-Station Manifold

Spare hardware and closing plates available. Add -M5 for metric ports.

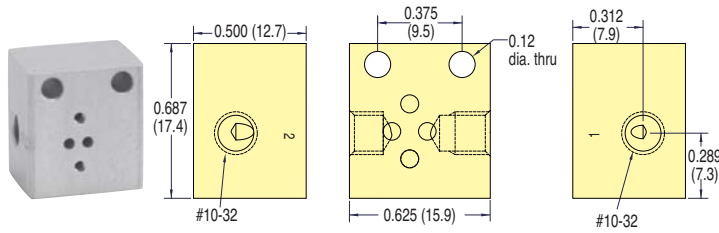

Part No.	Description
E10HM-01	10 mm Single-Station Manifold

Functional Schematics

